

Floor Elements  
地面组件

Castor  
脚轮

Material and Color: Base-carbon steel, plastic powder coated, black Wheel-polyurethane  
材质和颜色: 底座-碳钢喷塑 黑色 轮-聚氨酯

Castor-Thread-Universal  
脚轮-牙杆-万向

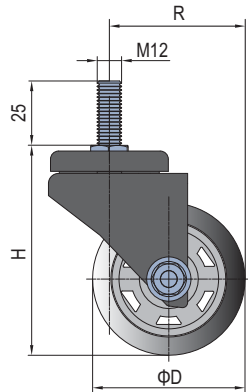

Castor-Thread-Brake  
脚轮-牙杆-刹车

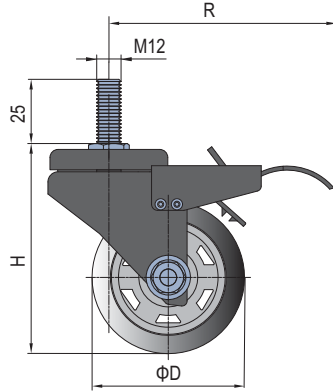

Castor-Plate-Universal  
脚轮-底盘-万向

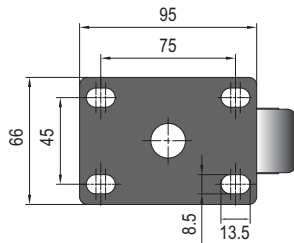
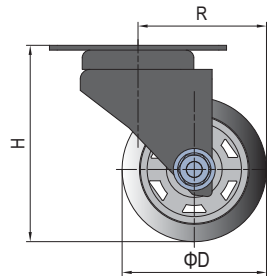

Castor-Plate-Fixed  
脚轮-底盘-定向

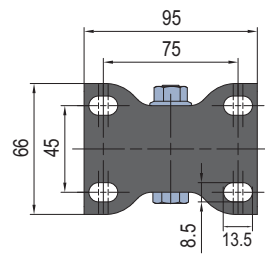
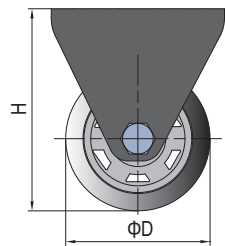

Castor-Plate-Brake  
脚轮-底盘-刹车

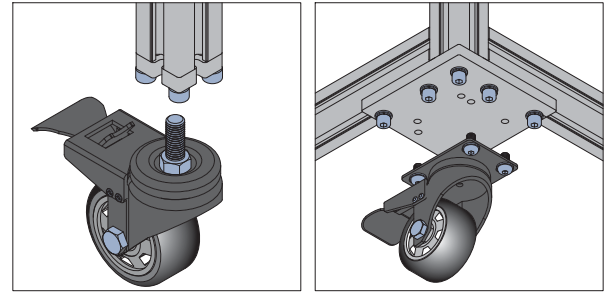
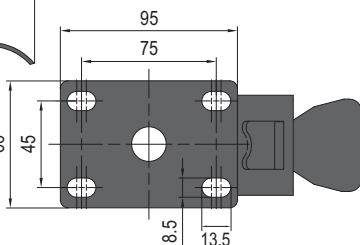
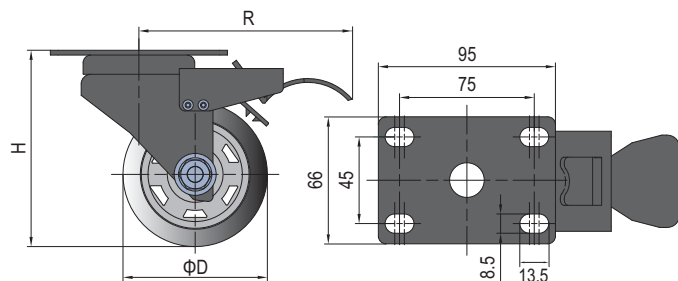

Castor-Plate-Universal-Heavy  
脚轮-底盘-万向-重载

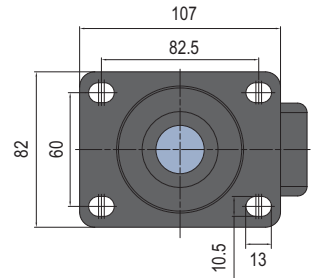
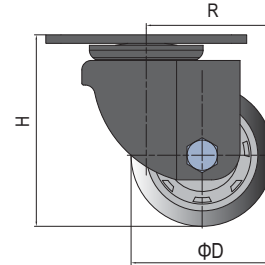

Castor-Plate-Fixed-Heavy  
脚轮-底盘-定向-重载

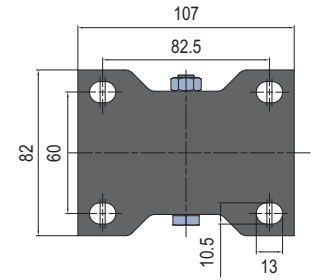
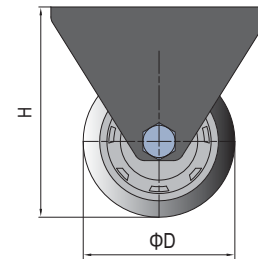

Description 产品描述	D (mm)	R (mm)	H (mm)	Load 载荷 (N)	Mass 重量 (g)	Part No. 订购编号
Castor-Thread-Universal 脚轮-牙杆-万向	63	63	92	800	550	5.41.63.M12
	75	73	107	1050	670	5.41.75.M12
	100	87	130	1350	790	5.41.100.M12
Castor-Thread-Brake 脚轮-牙杆-刹车	63	103	92	800	650	5.41.63.M12B
	75	103	107	1050	770	5.41.75.M12B
	100	111	130	1350	930	5.41.100.M12B
Castor-Plate-Fixed 脚轮-底盘-定向	63		92	800	370	5.41.63F
	75		107	1050	490	5.41.75F
	100		130	1350	670	5.41.100F
Castor-Plate-Universal 脚轮-底盘-万向	63	63	92	800	570	5.41.63U
	75	73	107	1050	690	5.41.75U
	100	87	130	1350	870	5.41.100U
Castor-Plate-Brake 脚轮-底盘-刹车	63	103	92	800	670	5.41.63B
	75	103	107	1050	790	5.41.75B
	100	111	130	1350	970	5.41.100B
Castor-Plate-Universal-Heavy 脚轮-底盘-万向-重载	75	65	104	6000	1150	5.41.75UH
Castor-Plate-Fixed-Heavy 脚轮-底盘-定向-重载	75		104	6000	950	5.41.75FH